

# Duct Connected -High Static Pressure- FDU



**New!**



FDU45-160



FDU224 · 280

## Remote control (option)

Wired



Wireless



RCN-KIT4-E2

## R32 Leak detector and shut-off valve available as an option

Refrigerant leak detector  
RLD-KIT-E

Shut-off valve  
SV-KIT-S1N-E  
SV-KIT-L1N-E



\*R32 indoor unit are not compatible with R410A outdoor unit and vice versa.

## Static pressure could be adjusted via the remote control



The static pressure of the air duct could simply be adjusted via the remote control thereby work above the ceiling to adjust is no longer required.

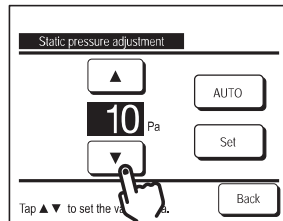
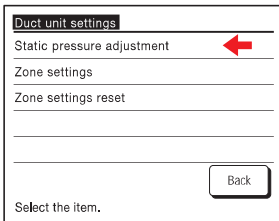

## Thin design

The height of FDU (45-160) models are only 280mm

280mm



## Transparent inspection window

Dirt condition of the bottom of the drain pan can be checked through this transparent inspection window without removing drain pan. (Please refer to P80)

## Improvement of the serviceability

Fan unit (impeller and motor) can be pulled out from the right side of the unit. Maintenance can be carried out from the right side or the bottom side of the unit.

## Reduction of sound pressure level

Previous (R410A) Current (R32) (P-Hi cooling mode)

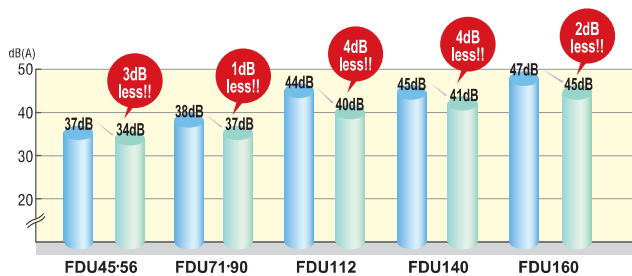

## Motion Sensor

(option)

Motion sensor is equipped in the ceiling plane or wall plane and detects the presence/absence and activity of humans in a room to improve the comfort and energy saving performance of the unit.



LB-KIT2

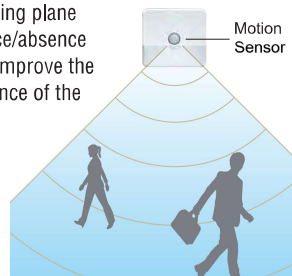

## Unit image

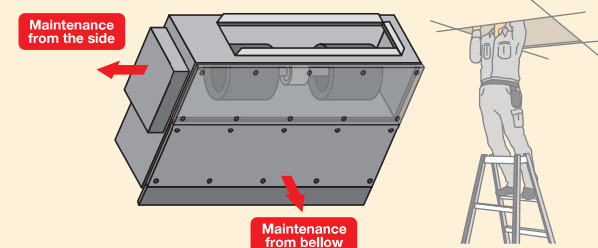

## Opening from the side

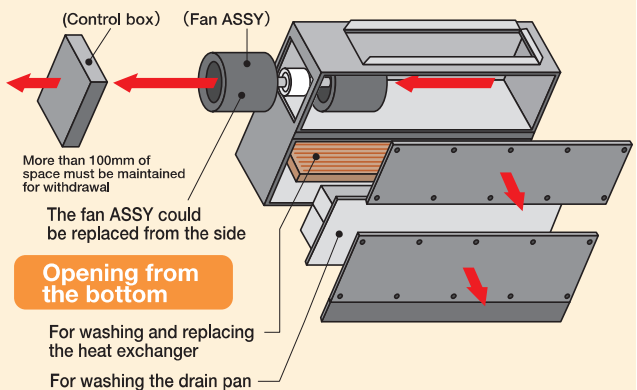

## SPECIFICATIONS

Indoor unit			FDU	45KXE3-W	56KXE3-W	71KXE3-W	90KXE3-W	112KXE3-W	140KXE3-W	160KXE3-W	224KXE3-W	280KXE3-W
Power source				1 Phase 220-240V, 50Hz								
Nominal capacity	Cooling	kW		4.5	5.6	7.1	9.0	11.2	14.0	16.0	22.4	28.0
	Heating			5.0	6.3	8.0	10.0	12.5	16.0	18.0	25.0	31.5
Power consumption	Cooling	W		100-100		240-250		310-320	350-360	420-430	1.160-1.200	
	Heating											
Sound power level <sup>1</sup>	Cooling	dB(A)		58		63		68		72	78	
	Heating			60		65		69				
Sound pressure level <sup>1</sup> (P-Hi/Hi/Me/Lo)	Cooling	dB(A)		34/29/27/25		37/31/27/22		40/36/34/28		41/37/34/28	45/38/34/29	52/50/47/44
	Heating			35/30/29/25		39/33/28/23		41/36/34/28				
Exterior dimensions (HxWxD)		mm		280x750x635		280x950x635		280x1368x738			379x1600x893	
Net weight		kg		29		34		54			89	
Air flow (P-Hi/Hi/Me/Lo)	Cooling	m <sup>3</sup> /min		13/10/9/8		24/19/15/10		36/28/25/19	39/32/26/20	48/35/28/22	80/72/64/56	
	Heating											
Available static pressure		Pa		200								
Outside air intake				Possible								
Refrigerant piping size	Liquid	mm (in)		ø6.35(1/4") (Flare)		ø9.52(3/8")(Flare)					ø9.52(3/8")(Brazing)	
	Gas			ø12.7(1/2")(Flare)		ø15.88(5/8")(Flare)					ø19.05(3/4") (Brazing)	ø22.22(7/8") (Brazing)
Air filter, Q'ty				Procure locally								

Indoor unit			FDU	45KXE6F	56KXE6F	71KXE6F	90KXE6F	112KXE6F	140KXE6F	160KXE6F	224KXE1	280KXE1
Power source				1 Phase 220-240V, 50Hz								
Nominal capacity	Cooling	kW	4.5	5.6	7.1	9.0	11.2	14.0	16.0	22.4	28.0	
	Heating		5.0	6.3	8.0	10.0	12.5	16.0	18.0	25.0	31.5	
Power consumption	Cooling	W	100-100		240-250		310-320	350-360	420-430	1.160-1.200		
	Heating											
Sound power level <sup>1</sup>	Cooling	dB(A)	60		65		71	72	74	75		
	Heating											
Sound pressure level <sup>1</sup> (P-Hi/Hi/Me/Lo)	Cooling	dB(A)	37/32/29/26		38/33/29/25		44/38/36/30	45/40/34/29	47/40/35/30	52/50/47/45		
	Heating											
Exterior dimensions (HxWxD)		mm	280x750x635		280x950x635		280x1368x740			379x1600x893		
Net weight		kg	29		34		54			89		
Air flow (P-Hi/Hi/Me/Lo)	Cooling	m <sup>3</sup> / min	13/10/9/8		24/19/15/10		36/28/25/19	39/32/26/20	48/35/28/22	80/72/64/56		
	Heating											
Available static pressure		Pa	200									
Outside air intake			Possible									
Refrigerant piping size	Liquid	mm (in)	ø6.35(1/4")(Flare)		ø9.52(3/8")(Flare)					ø9.52(3/8")(Brazing)		
	Gas		ø12.7(1/2")(Flare)		ø15.88(5/8")(Flare)					ø19.05(3/4") (Brazing)	ø22.22(7/8") (Brazing)	
Air filter, Q'ty			Procure locally									

1. The data are measured under the following conditions(ISO-T1). Cooling: Indoor temp. of 27°CDB, 19°CWB, and outdoor temp. of 35°CDB. Heating: Indoor temp. of 20°CDB, and outdoor temp. of 7°CDB, 6°CWB.  
2. Sound pressure level indicates the value in an anechoic chamber. During operation these values are somewhat higher due to ambient conditions.

### Round duct adapter (Available for FDU 45–160, FDUM 22–160)

Company: AIRZONE  
URL: <http://www.airzone.es>

All-in-one solution: the whole zoning system in a plug&play device perfectly adapted to the indoor DX unit

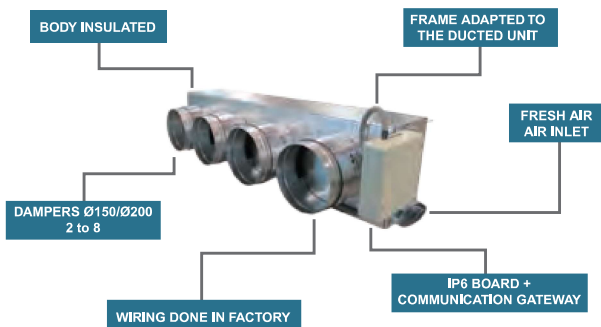

### Main components

